

COMPACT DIAL INDICATORS

- Meet ASME B89.1.10M-2001
- With lug back
- Supplied with limit pointers and bezel clamp
- Optional accessory: backs (page 74), contact points (page 73)



2304-01

**INSPECTION
CERTIFICATE**
TRACEABLE TO NIST

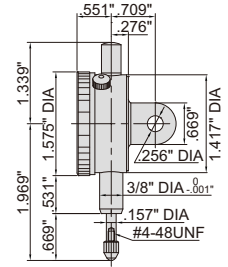

Part No.	Range	Graduation	Accuracy		Range/rev	Dial reading
			First 2.5 rev	Overall		
2304-01 *	.1"	.001"	—	±.001"	.1"	0-100
2304-02 *	.2"	.001"	—	±.001"	.1"	0-100
2304-025 *	.25"	.001"	±.001"	±.001"	.1"	0-100
2304-015 *	.1"	.0005"	—	±.0005"	.05"	0-50
2304-0205 *	.2"	.0005"	±.0005"	±.0015"	.05"	0-50
2304-0255 *	.25"	.0005"	±.0005"	±.0015"	.05"	0-50

* Supplied with manufacturer inspection certificate traceable to NIST

DIAL INDICATORS

- Meet ASME B89.1.10M-2001
- With lug back
- Supplied with limit pointers and bezel clamp
- Optional accessory: backs (page 74), contact points (page 73)



2307-1

**INSPECTION
CERTIFICATE**
TRACEABLE TO NIST

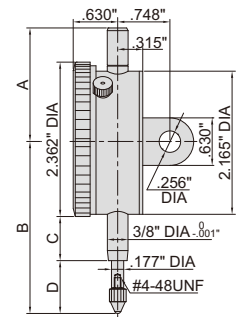

Part No.	Range	Graduation	Accuracy		Range/rev	Dial reading
			First 2.5 rev	Overall		
2307-025 *	.25"	.001"	±.001"	±.001"	.1"	0-100
2307-05 *	.5"	.001"	±.001"	±.002"	.1"	0-100
2307-1 *	1"	.001"	±.001"	±.002"	.1"	0-100
2307-2 *	2"	.001"	±.001"	±.004"	.1"	0-100
2307-0255 *	.25"	.0005"	±.0005"	±.0015"	.05"	0-50
2307-055 *	.5"	.0005"	±.0005"	±.0015"	.05"	0-50
2307-105 *	1"	.0005"	±.0005"	±.002"	.05"	0-50
2307-205 *	2"	.0005"	±.0005"	±.002"	.05"	0-50

Range	A	B	C	D
.25"	1.811"	2.953"	.787"	.984"
.5"	1.811"	2.953"	.787"	.984"
1"	1.811"	3.346"	.787"	1.378"
2"	4.370"	5.472"	1.969"	2.323"

* Supplied with manufacturer inspection certificate traceable to NIST

REVERSE READING DIAL INDICATOR

- Meet ASME B89.1.10M-2001
- With lug back
- Supplied with limit pointers and bezel clamp
- Optional accessory: backs (page 74), contact points (page 73)



2307-1R

**INSPECTION
CERTIFICATE**
TRACEABLE TO NIST

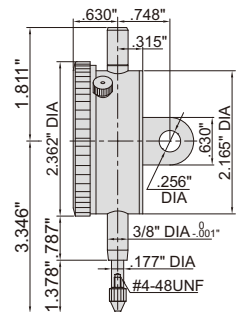

Part No.	Range	Graduation	Accuracy		Range/rev	Dial reading
			First 2.5 rev	Overall		
2307-1R *	1"	.001"	±.001"	±.002"	.1"	100-0

* Supplied with manufacturer inspection certificate traceable to NIST